



**PRODUCT SPECIFICATIONS:**

- Maximum operating temperature: 100°C
- Maximum operating pressure: 10bar
- Maximum flow rate: 50 L/min
- Magnet: Neodymium
- Filter material: Brass
- Net weight (filter and isolating valves) 1.65kg
- Gross weight 1.78kg

**WARNING!** This filter contains a strong magnet. Keep away from electrical devices, bank cards and other magnetic devices.

**WARNING!** This filter contains a strong magnet. Handle with care if you have a pacemaker fitted.

**WARNING!** Unit may be hot in operation. Handle with care.

**IMPORTANT!** Always follow the Standard Electrical Best Practice guidelines when installing an Ideal System Filter.

A copy of these guidelines can be found at [www.hse.gov.uk/electricity](http://www.hse.gov.uk/electricity)

It is recommended that the filter is installed by a qualified heating engineer. To prevent frost damage, do not install externally.

# Register your warranty now on **Connect!**

Thank you for purchasing your Ideal System Filter. Your filter is supported by a 10\* year warranty\*\*. For a period of ten\* years from the date of installation, the warranty covers your filter against defective material or manufacture.

If the product fails to meet published specifications due to a defect in materials or manufacture, we will repair or replace the defective unit free of charge.



**REGISTER YOUR WARRANTY**

Register your filter with your Ideal boiler on [installerconnect.com](http://installerconnect.com) for reward points.

The serial number is located on the label or on the product.

\*When installed with an eligible Ideal Vogue Max, 12 years.  
\*\*When registered with a new boiler on Connect within 30 days

Customer Service:  
**01482 498660**

Technical Help:  
**01482 498663**

Ideal Boilers, PO Box 103, National Avenue, Kingston upon Hull, East Yorkshire, HU5 4JN

E: [enquiries@idealboilers.com](mailto:enquiries@idealboilers.com)

[idealheating.com](http://idealheating.com) |

**WARRANTY TERMS & CONDITIONS**

This warranty is in addition to, and does not limit your statutory rights.

Warranty is subject to the terms and conditions detailed, to repair or, at our discretion, replace the defective unit free of charge.

**REGISTER YOUR WARRANTY ON INSTALLER CONNECT OR IDEALBOILERS.COM**

**TERMS & CONDITIONS**

- The unit has been installed correctly and maintained and serviced in accordance with the instructions. This warranty will not cover damage or defects caused as a result of faulty installation or improper maintenance or servicing.
- The unit has not been tampered with or otherwise subjected to misuse, fire, accidental damage or negligence.
- The unit has not been modified or repaired except by a person authorised to do so.
- The serial number has not been removed or made illegible.
- The unit is returned to us at your own cost or delivered to our appointed representative together with proof of purchase (in the form of a receipt or invoice).
- The unit is returned promptly on being found to be defective.
- The sole and exclusive remedy under this warranty is for the repair or replacement (at Ideal Heating discretion) of the unit and no other remedy, including but not limited to incidental or consequential damage or loss of whatsoever nature, shall be available. Ideal Heating reserves the right to undertake the least costly option available. The amount of any claim under this warranty shall be limited to the original purchase price paid for the defective unit.
- All personal data that we collect from you as part of the warranty registration process will be used by Ideal Heating in order to maintain the validity of this warranty. We may also use the details provided to email you about new products, discounts or upcoming events which we feel may interest you where you have provided your consent for us to do so.
- Our decision on all matters relating to warranty claims shall be final.
- The Ideal System Filter comes with a ten\* year limited warranty of the filter body and magnet assembly within operational temperatures of up to 95°C.
- The warranty period will be for a period of up to ten\* years from the date of registration, or for the life of the boiler to which the Ideal System Filter is fitted, whichever comes first.
- In the case of Max boilers, both the boiler and included system filter need to be registered simultaneously within 30 days of installation to qualify for the full warranty period. Should these conditions not be met then the period of warranty will extend to only 12 months from installation.
- Replacement under warranty does not restart the warranty period.
- The magnet must be kept clean and dry at all times. Should the operating temperature exceed 95°C, the pressure of the system exceed 4.5 bar or the flow rate exceed that which is stated in the Product Data Sheet, the warranty will be void.
- To prevent further corrosion taking place within a central heating system, a quality inhibitor must be used in conjunction with the installation of an Ideal System Filter. The warranty will be void if it should be found that a system where an Ideal System Filter was fitted did not contain a chemical inhibitor. Inhibitor levels should be checked on an annual basis.
- All non-metal filter parts e.g. rubber seals, connection valve rubber components (e.g. O-rings) are covered by a warranty of 2 years from date of installation.



# Ideal System Filter



Magnetic filter



Easy to install



High capacity

**INSTALLATION & MAINTENANCE GUIDE**

[idealheating.com](http://idealheating.com) |

# Ideal System Filter Installation & Maintenance Guide

The Ideal System Filter is an efficient, full-flow, magnetic filter designed to protect central heating systems by removing suspended debris, including iron oxide. Even a small build-up of iron oxide debris in a heating system results in substantial efficiency loss and energy wastage. Not only does the system perform inadequately, it costs more to run and maintain.

## FEATURES & BENEFITS

- High capacity and compact design
- Collects magnetic and non-magnetic debris
- No lid to remove for dosing to prevent potential leaks
- Will not block flow
- Fast and easy to clean without dismantling unit
- Low pressure drop - maintains system energy efficiency
- Easy to install, pipework orientation unlimited
- Flexible installation options - can be used with valves or as a slipsocket connection
- Powerful dry pocket magnet assembly
- Simple chemical dosing via the drain valve
- Flushing adaptor available

## COMBI/SEALED SYSTEM

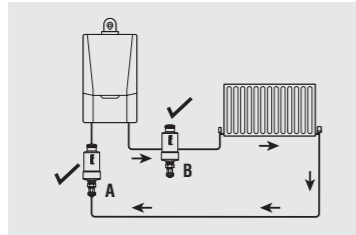

## OPEN VENTED SYSTEM

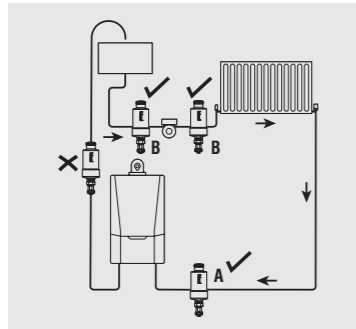

The System filter can be installed anywhere on the heating system before the boiler. For optimum protection, fit the filter at point A, if this is not possible fit at point B.

## PRESSURE LOSS (WITH VALVES)

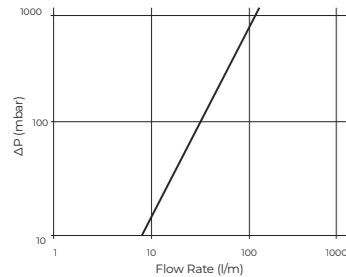

## INSTALLATION OF THE IDEAL SYSTEM FILTER

The system filter has the following parts: body with removable magnet, manifold, drain valve with cap, isolation valves, nuts, olives and washers. The black rubber washer locates between the drain valve and the filter body. The white washers locate between the isolation valves and the manifold.

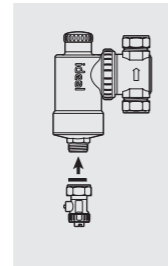
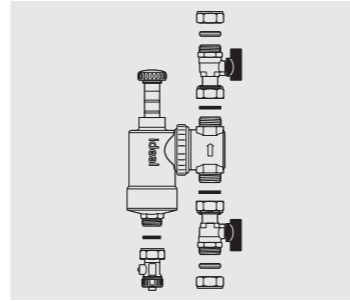

1. Drain valve to be fitted to base of filter, using the black washer

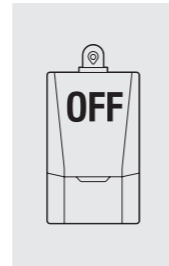

2. Switch off boiler and drain system

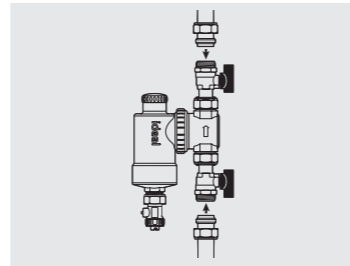

3. Connect the filter to the pipework in one of 3 different ways. Option 1: using two valves. Insert the white seals between the manifold and valves

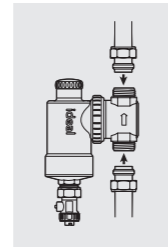

4. Option 2: connect the filter using the nuts and rings

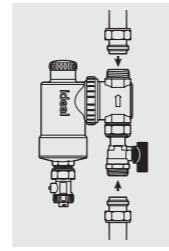

5. Option 3: connect the filter using one valve and one nut and ring

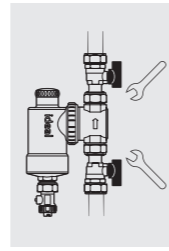

6. Tighten all connections



7. Switch on boiler

## CHANGING ORIENTATION

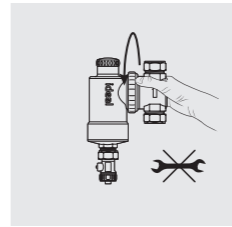
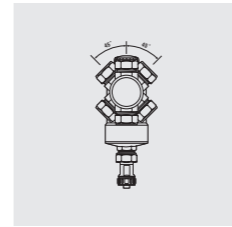
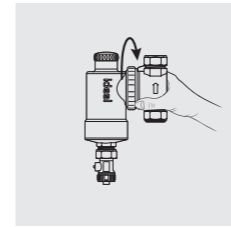

## SERVICING THE IDEAL SYSTEM FILTER

**ADVICE:** Annual service is recommended  
**ADVICE:** Place container and towel under the filter when servicing.

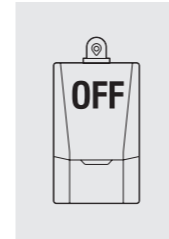

1. Switch off boiler

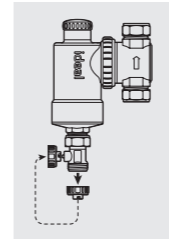

2. Remove drain valve cap

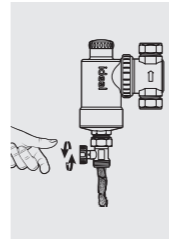

3. Use drain valve cap to open drain valve

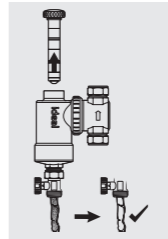

4. Remove the magnet Flush out the filter until water runs clear

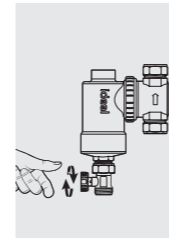

5. Close drain valve

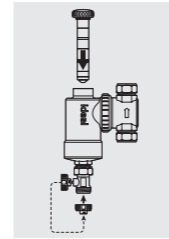

6. Replace magnet and drain valve cap

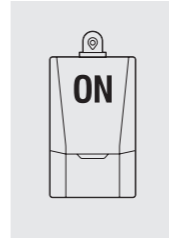

7. Switch on boiler

**NB:** system pressure may need topping up after servicing. Refer to boiler user or installation instructions.  
**WARNING!** Ensure magnet pocket is kept dry.

## CHEMICAL DOSING USING THE IDEAL SYSTEM FILTER

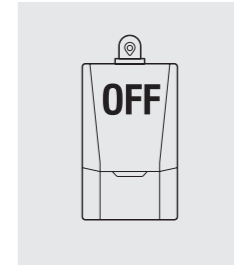

1. Switch off boiler

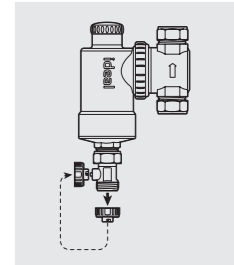

2. Remove drain valve cap

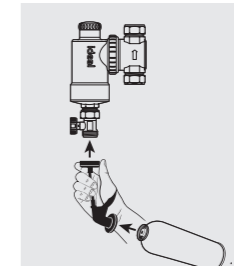

3. Attach dosing method to drain valve

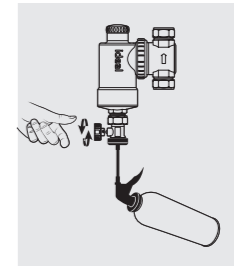

4. Use drain valve cap to open drain valve

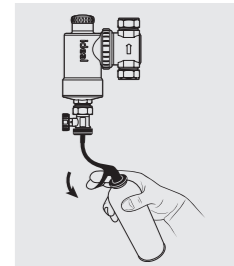

5. Dose System

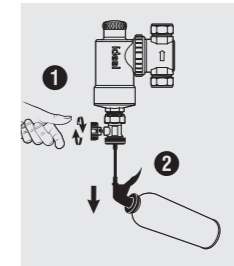

6. Close drain valve. Remove the dosing method from the drain valve

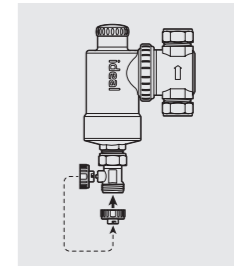

7. Replace drain valve cap

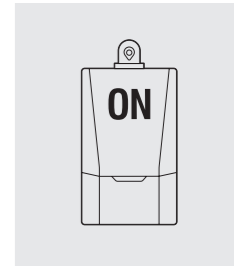

8. Switch on boiler